

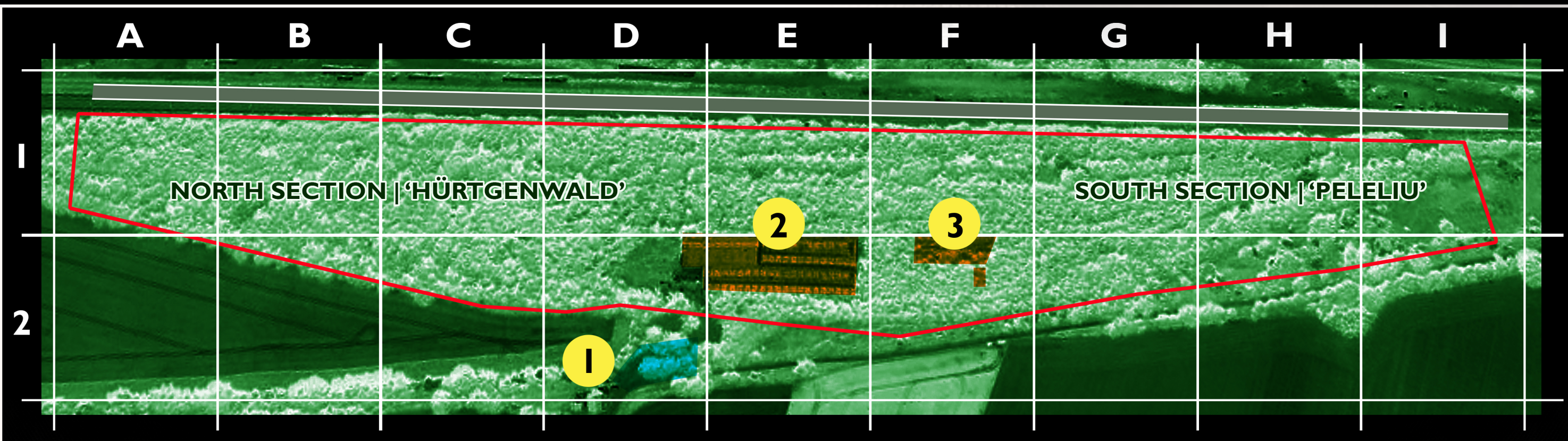

TRANCENTRAL

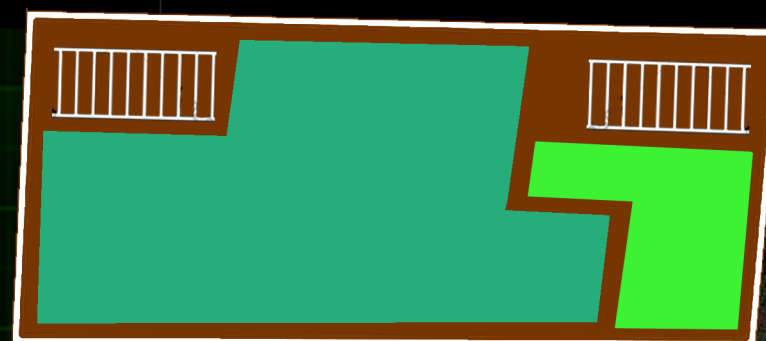

GROUND FLOOR CENTRAL STATION

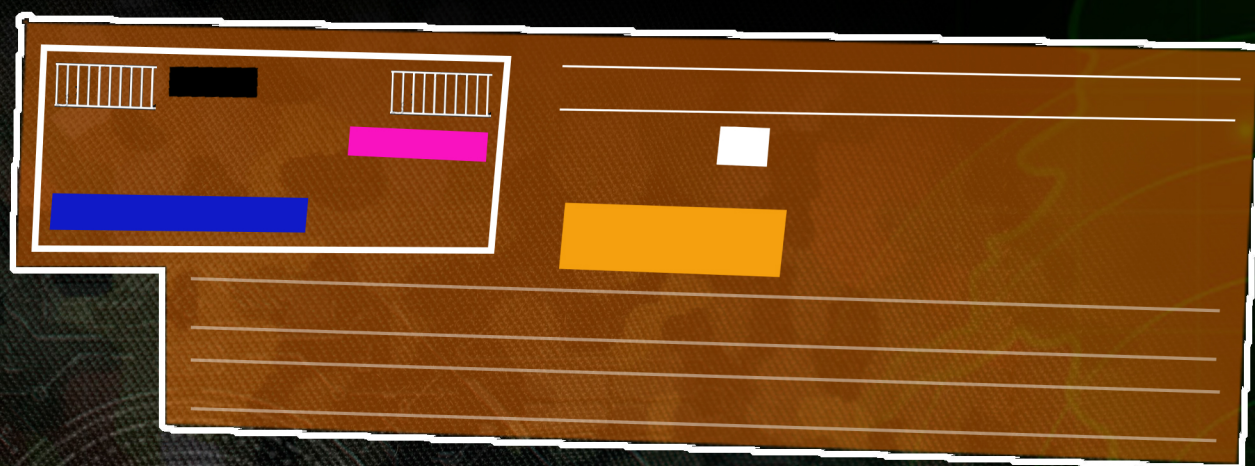

SECOND FLOOR CENTRAL STATION

1 UN SAFETY ZONE 2 CENTRAL STATION 3 GREY WOLF'S LAIR

TRANCENTRAL LEGENDA

GROUND FLOOR

- DPD KOTJE
- CIGAR CAVE
- RAVIOLI'S FAVELA
- TINA'S TOILET SECTION
- SOUTHERN KNIGHTS INN

SECOND FLOOR

- TIER ONE RABBITS DINING
- TOOTHFAIRY'S PENTHOUSE



AIRSOFT VETS